

Ordinance 2023-21 to create a Planned Unit Development known as Nance Street International Residence Hall Planned Unit Development and to rezone ~7.62 acres at the corner of Robert Grissom Pkwy & Mr. Joe White Ave (PIN 425-13-01-0080) from HC2 (highway commercial) to PUD (Nance Street International Residence Hall Planned Unit Development) to provide safe housing for seasonal international workers.

Planning Commission: 4/4/2023, voted unanimously 5/0 to recommend approval with the further recommendation that City Council and the developer consider ways in which the project can cohesively blend into the neighborhood, and that the public improvements are properly financed and executed.

Proposed Location



Robert M Grissom Pkwy



Mr. Joe White Ave

Canal St

Luther Senior Ln

Thompson St

Nance St

Amber St

Blue St

Nance St

Eastbrook

Mako Ct

Fisher

Current Zoning

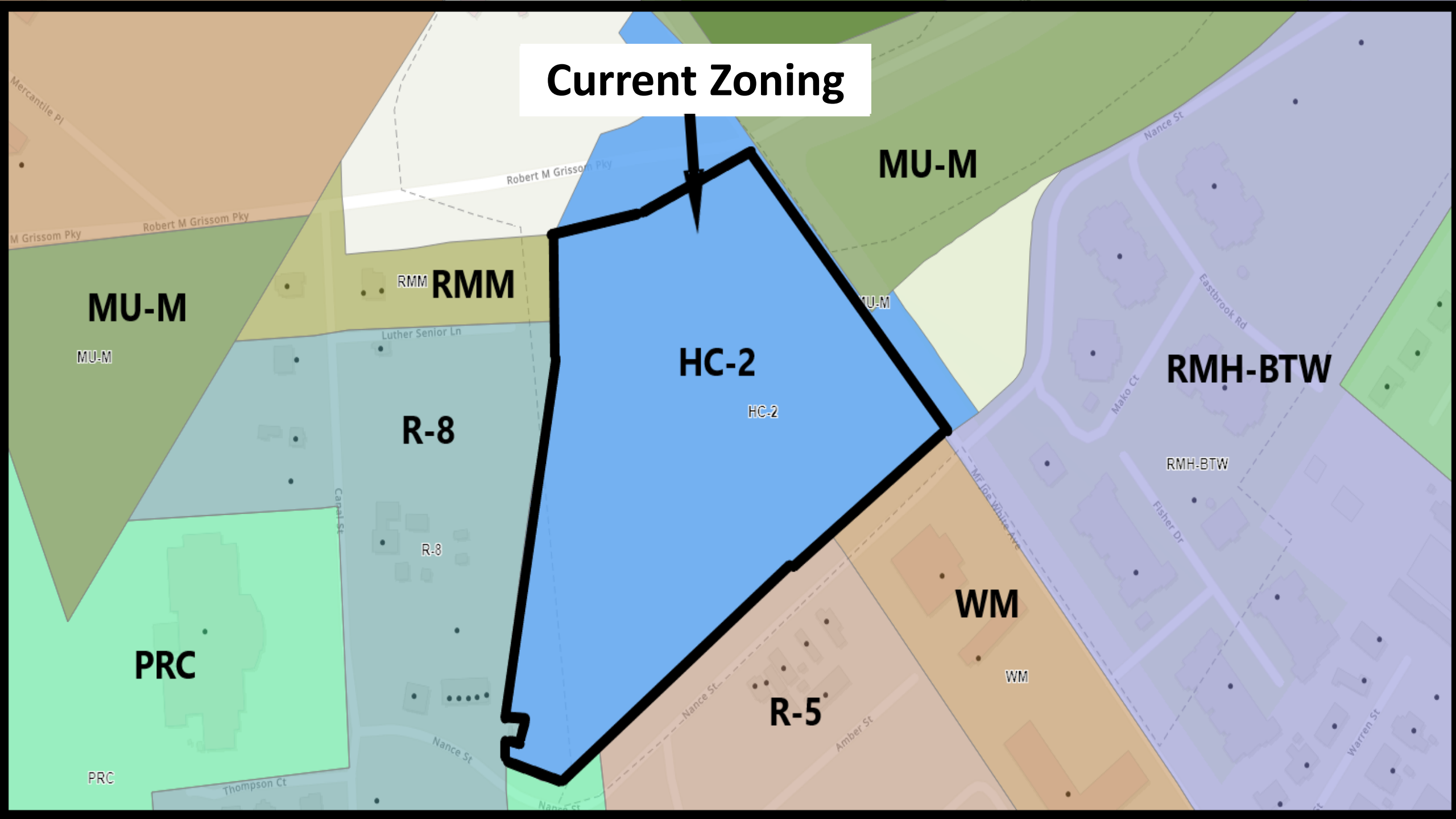

UNITS PER BUILDING 81

OCCUPANTS PER BUILDING

BUILDING 1 314

BUILDING 2 310

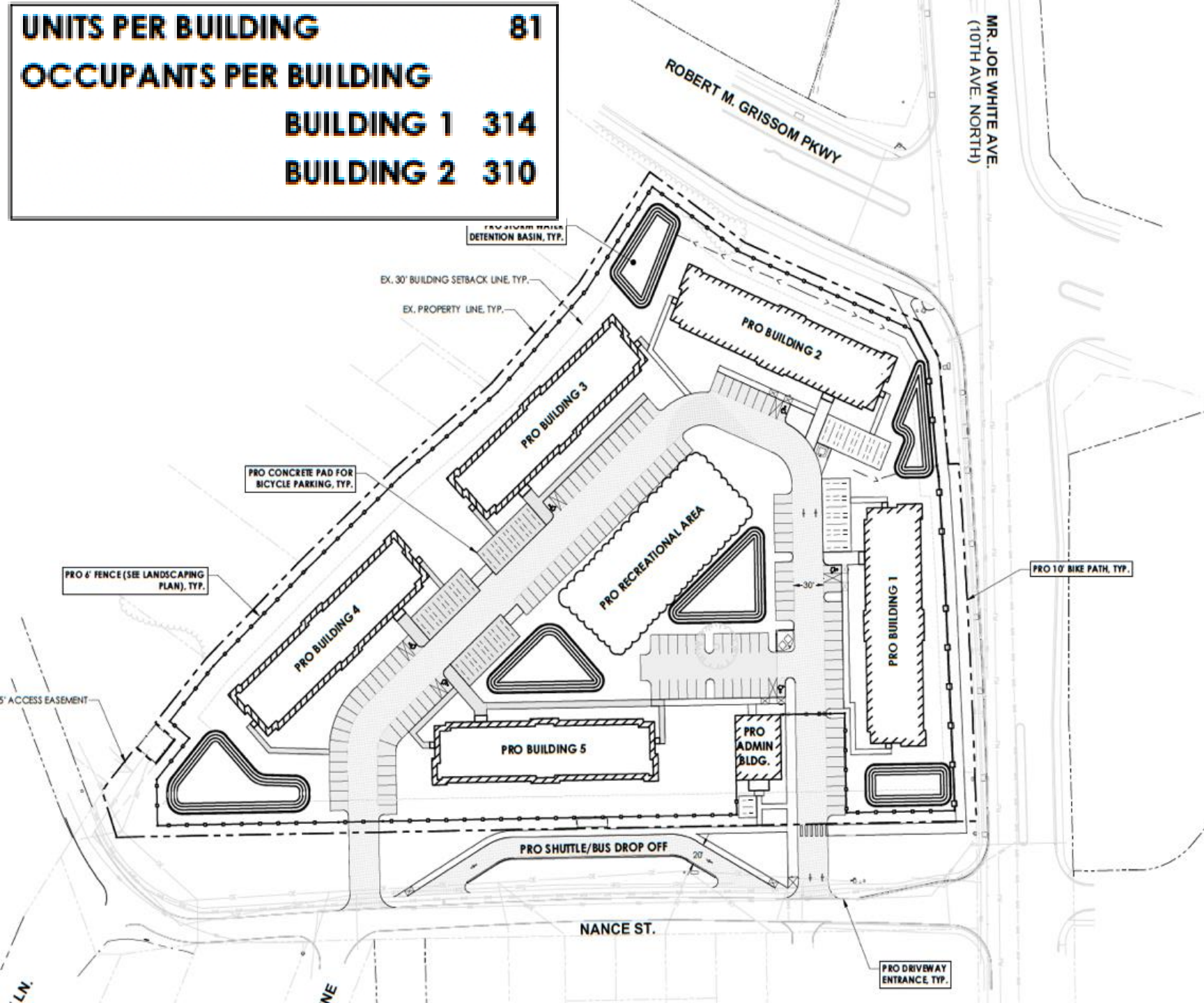

Proposed Site Plan

PUD Details:

- Only permitted use is dorm style residences & related amenities.
- Reduced Car Parking, Increased Bicycle Parking
- 6' Fence on All Sides

Phase One: 2 Years
Final Phase: 6 Years

Public Improvements

UNDERGROUND UTILITY LOCATIONS ARE INDICATED BY DASHED LINES AND SHOULD BE FIELD VERIFIED PRIOR TO CONSTRUCTION.

NOTES FOUND ON SHEET G1.1.

LOADING	81
PER BUILDING	
BUILDING 1	314
BUILDING 2	310

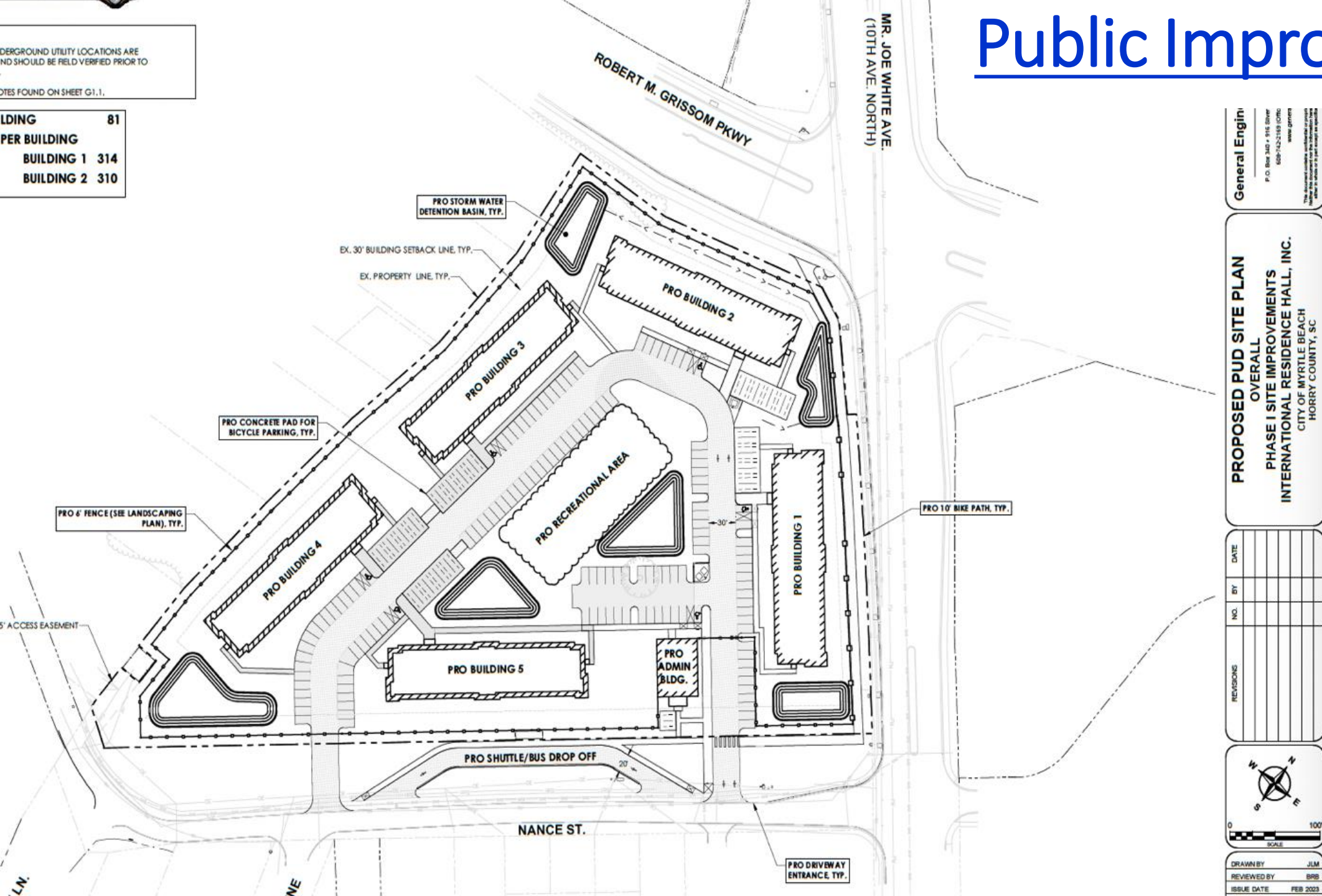

General Engine
 P.O. Box 340 • 916 River
 689-742-2189 (OTD)
 www.greiner.com
The enclosed liability certificate is provided for the convenience of the customer. It does not constitute an offer of insurance or any other financial product.

PROPOSED PUD SITE PLAN
 OVERALL
 PHASE I SITE IMPROVEMENTS
 INTERNATIONAL RESIDENCE HALL, INC.
 CITY OF MYRTLE BEACH
 Horry County, SC

REVISIONS	NO.	BY	DATE



DRAWN BY: JLM
 REVIEWED BY: BRB
 ISSUE DATE: FEB 2023

Public Improvements

Stormwater Improvements to alleviate existing Harlem Neighborhood Drainage Issues

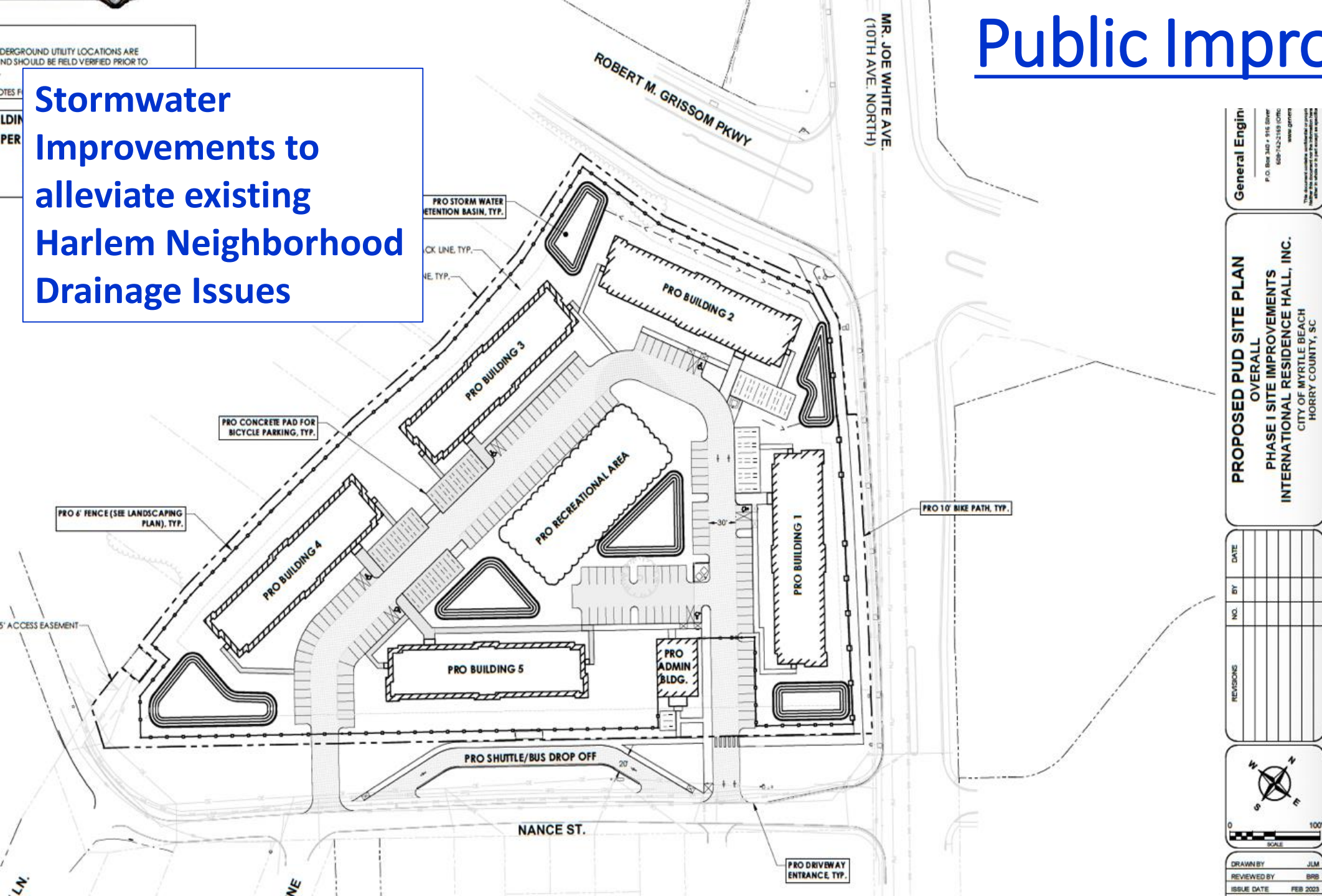

General Engine
P.O. Box 340 • 916 Silver
689-742-2189 (OTD)
www.gemco.com

The attached drawings are the property of General Engine. No part of this document may be reproduced or transmitted in any form or by any means electronic or mechanical, including photocopying, recording, or by any information storage and retrieval system, without the prior written permission of General Engine.

**PROPOSED PUD SITE PLAN
OVERALL
PHASE I SITE IMPROVEMENTS
INTERNATIONAL RESIDENCE HALL, INC.
CITY OF MYRTLE BEACH
HORRY COUNTY, SC**

REVISIONS	NO.	BY	DATE



DRAWN BY: JLM
REVIEWED BY: BRB
ISSUE DATE: FEB 2023

Public Improvements

Stormwater Improvements to alleviate existing Harlem Neighborhood Flooding

New Bicycle Path to Connect to the East Coast Greenway

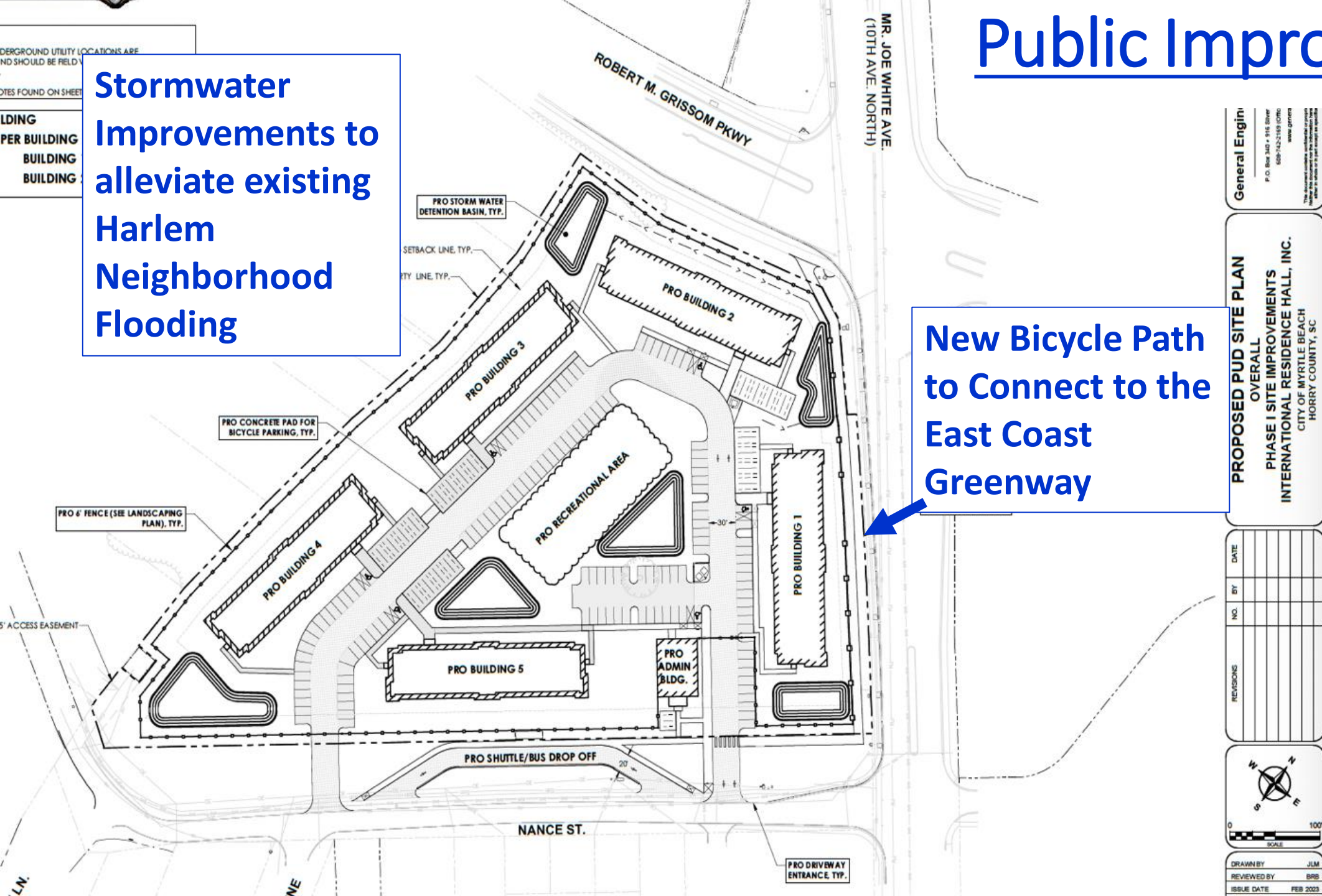

General Engin
P.O. Box 340 • 916 Silver
689-742-2189 (OTD)
www.geneng.com

PROPOSED PUD SITE PLAN
OVERALL
PHASE I SITE IMPROVEMENTS
INTERNATIONAL RESIDENCE HALL, INC.
CITY OF MYRTLE BEACH
HORRY COUNTY, SC

REVISIONS	NO.	BY	DATE



DRAWN BY: JLM
REVIEWED BY: BRB
ISSUE DATE: FEB 2023

Public Improvements

Stormwater Improvements to alleviate existing Harlem Neighborhood Flooding

Coast RTA Bus Shelter & Ride Share Pick Up/Drop Off

New Bicycle Path to Connect to the East Coast Greenway

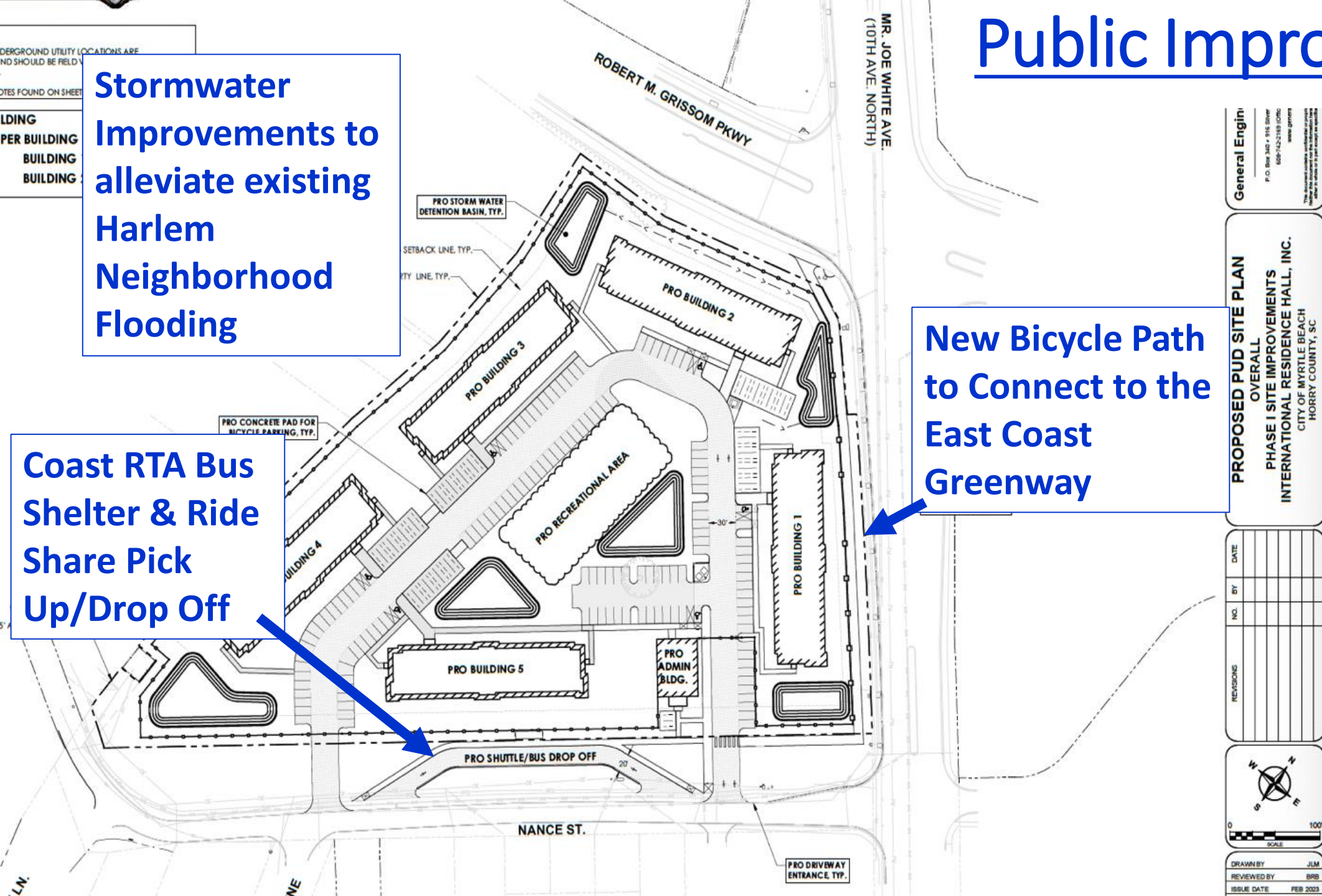

General Engin
P.O. Box 340 • 916 River
689-142-2189 (OTD)
www.grener
The Architect hereby certifies that the information herein is true and correct to the best of his knowledge and belief.

PROPOSED PUD SITE PLAN
OVERALL
PHASE I SITE IMPROVEMENTS
INTERNATIONAL RESIDENCE HALL, INC.
CITY OF MYRTLE BEACH
HORRY COUNTY, SC

REVISIONS	NO.	BY	DATE



DRAWN BY JLM
REVIEWED BY BRB
ISSUE DATE FEB 2023

Public Improvements

Stormwater Improvements to alleviate existing Harlem Neighborhood Flooding

Coast RTA Bus Shelter & Ride Share Pick Up/Drop Off

New Bicycle Path to Connect to the East Coast Greenway

Mr. Joe White Ave Turning Improvements

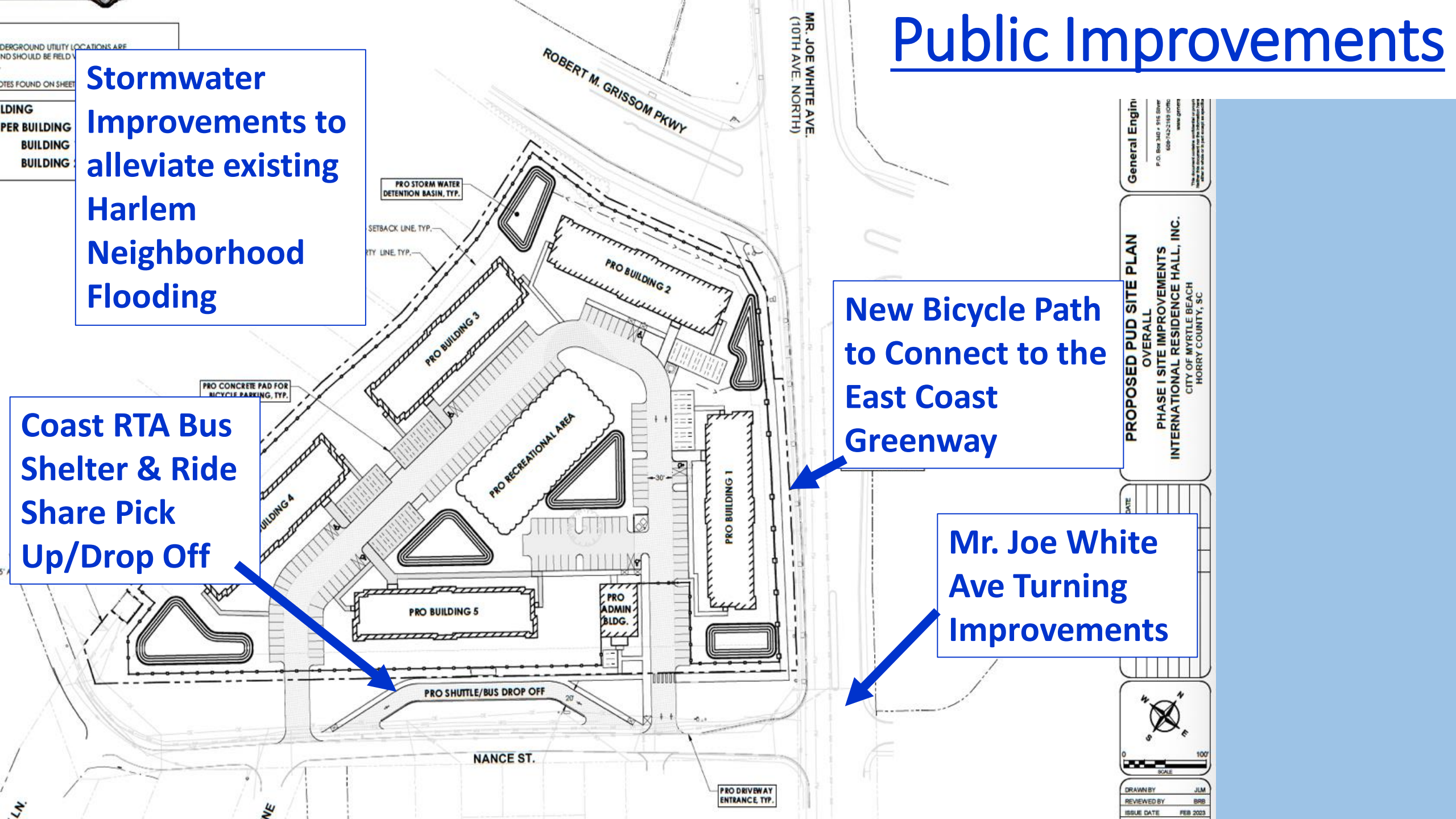

General Engin
P.O. Box 340 • 916 Silver
689-742-2189 (OTD)
www.gemcon.com

PROPOSED PUD SITE PLAN
OVERALL
PHASE I SITE IMPROVEMENTS
INTERNATIONAL RESIDENCE HALL, INC.
CITY OF MYRTLE BEACH
HORRY COUNTY, SC

DATE



DRAWN BY JLM
REVIEWED BY BRB
ISSUE DATE FEB 2023